

AIR BLEED SCREW  
#8-32UNC-2B BH SOCKET HEAD CAP SCREW  
TORQUE TO 10 ± 1 IN-LBS

STAT-O-SEAL #8

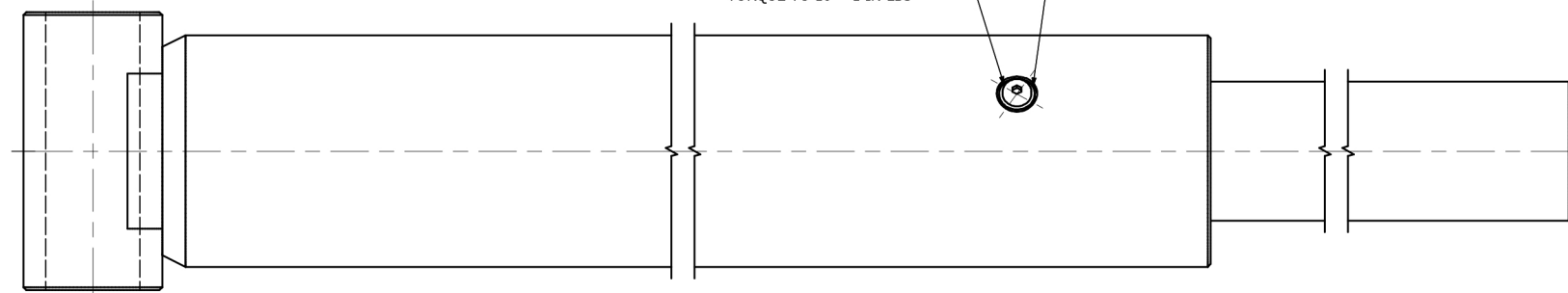

NOTE: 1. PAINT PRIMER PER ENERGY SPECIFICATION ES0143

2. CYLINDER MUST BE OILED TESTED

### CYLINDER RATING

CYLINDER PRESSURE RATING	2,500 PSI
OPERATING TEMPERATURE RANGE	-40° F TO 200° F
MINIMUM STRUCTURAL SAFETY FACTOR	2:1
MINIMUM WALL BURST PRESSURE	13,650 PSI
MAXIMUM RECOMMENDED ROD SPEED	100 FT/MIN
MINIMUM RECOMMENDED ROD SPEED	5 FT/MIN
*** ROD SPEEDS UNDER 5 FT/MIN MAY CAUSE SEAL NOISE DUE TO STICK/SLIP	
RECOMMENDED MAXIMUM COLUMN LOAD AT FULL EXTENSION WITH 2:1 SAFETY FACTOR, NO SIDE LOAD, PINNED ENDS AND NO INTERMEDIATE BRACING	17,700 LBS

SEAL KIT: 21170X

PINS: NOT FURNISHED

DO NOT SCALE PRINT		Weight: 25.9 lbmass	01
UNLESS OTHERWISE SPECIFIED LETTERS AFTER DIMENSIONS DEFINES TOLERANCES AS FOLLOWS:		THIRD ANGLE PROJECTION	
A +/- 0.0005	G +/- 0.010	Material:	
B +/- 0.0005	H +/- 0.020	HT Treat:	
C +/- 0.0005	J +/- 0.030	Finish:	
D +/- 0.001	K +/- 0.060	Drawn by:	Date:
E +/- 0.002	L +/- 0.125	Checked by:	Date:
F +/- 0.005	ANGLE +/- 2'	Approved by:	
		M.K.	7/18/2023

ALL DRAWINGS AND BLUEPRINTS SUPPLIED BY ENERGY MANUFACTURING CO. ARE SUBJECT TO PROTECTION UNDER THE UNITED STATES COPYRIGHT LAW, WHICH AMONG OTHER THINGS, PROHIBITS REPRODUCTION, DERIVATION OR DISTRIBUTION OF COPIES. THE DRAWINGS CONTAIN TRADE SECRETS OF ENERGY MANUFACTURING CO. AND ARE SUPPLIED TO THE VENDOR OR CUSTOMER ON A CONFIDENTIAL BASIS AND SHALL NOT BE DISCLOSED OR DISTRIBUTED TO OTHERS WITHOUT THE PRIOR EXPRESS WRITTEN PERMISSION OF ENERGY MANUFACTURING CO. ALL DRAWINGS AND OTHER WRITTEN MATERIALS PROVIDED TO THE VENDOR OR CUSTOMER SHALL BE RETURNED TO ENERGY MANUFACTURING CO. WHEN THE NEED FOR SUCH MATERIALS IS ENDED, OR UPON THE EARLIER DEMAND FOR THE RETURN OF THE MATERIALS BY ENERGY MANUFACTURING CO.